

ATTACHMENT #7

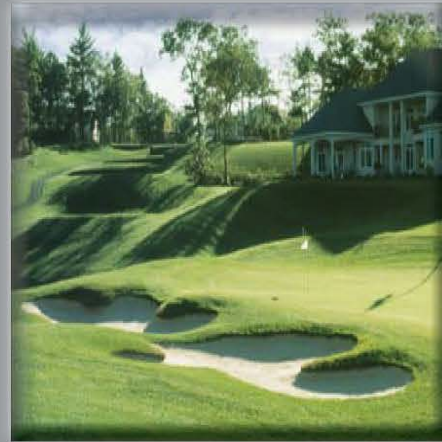

**WE BELIEVE GOLF SHOULD BE FUN.** We make our courses fun to play by carefully blending together simplicity, challenge, nuance, mystery, variety and beauty.

**WE BELIEVE THAT GREAT GOLF COURSES COME IN ALL SHAPES, SIZES, AND STYLES.** There are no formulas, signature features, or pre-determined styles in our work. Each of our designs is a response to the project's conditions and environment.

**WE BELIEVE IN CREATING VALUE FOR OUR CLIENTS.** Whether its a new course or the remodeling of an existing one, we make sure to know who the target market is and then we develop a design solution that respects both the construction and operations budgets.

**WE BELIEVE IN UNDERSTANDING AND RESPECTING THE HISTORY OF YOUR GOLF COURSE.** Our first step in the remodeling process is to research the origins of your club and become familiar with the design style and thinking of the original architect.



# On Design...



## **Our Promise to Our Clients:**

*To undertake a limited number of projects at any one time.*

*To listen to, and understand, your goals and objectives.*

*To handcraft your golf course so that it plays great for generations.*



# Our Services

## New Course Development

The core of our business is built around designing new golf courses. We'll be with you every step of the way, from initial site selection to opening day. Our design solutions are not based on "signature features" or "trade-marks." We prefer to treat each client as an individual and each site as unique. Our completed golf courses reflect the best use of the natural site features while meeting the objectives set forth by our clients.

Designing a new golf course is a privilege, and big responsibility. That's why we have made it a policy to only take on a few projects at any one time. We believe that our clients deserve our full personal attention. That's another reason why you'll only ever deal with Damian or Steve and your project won't be "staffed out" to a young associate.

We know that golf courses are not created in a vacuum. Today's projects generally require a slew of consultants to meet the demands of the regulators. We have exceptional skills in working alongside the planners, engineers, architects, and other members of the design team. We have the ability to produce full sets of detailed plans and specifications, and are well versed in the bidding and negotiation process with contractors. Perhaps our most important work takes place during construction. We love to spend our time on site working with the shapers and builders handcrafting all of the details that will add up to create a truly exceptional golf course.



# Our Services

## Strategic Planning for Existing Facilities

Charting future improvements for your course can be a daunting task. What do we need to do? How do we get started? What do our members think? These are some of the fundamental questions facing many green committees and Directors. Let us help you in these early stages. We'll review your golf course and bring to light issues you may not have considered. We will also meet with focus groups from the membership to gauge their interests and concerns. We can give you factual answers to some of the most basic questions to help you decide if you want to take the next step.

## Planned Improvements to the Golf Course

Creating a long or short term plan of improvements is the best way to keep your course in top shape. We build upon the information gained during the strategic planning phase to establish the goals and objectives for the project. After that, a series of design concepts are developed and refined to meet those goals. We work very closely with the leadership of the Club during this entire process until we finalize the plan. Our final documents include the plan, estimates of construction costs, and a strategy for implementation. We'll help you decide the best way to present the plan to the membership and assist you in that task.

## Implementation of the Improvement Plan

This is where we produce the necessary construction plans, specifications, and cost estimates to implement all or a portion of the improvement plan. We will help you select the right contractor to do the job and we will frequently be on site during construction.

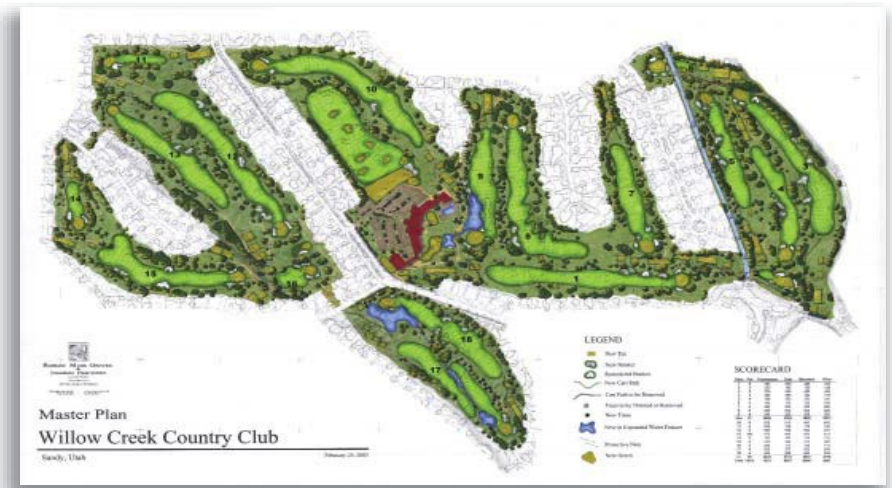

## Redesign of Specific Golf Course Features

Sometimes, only a small part of the golf course needs to be remodeled. We'll prepare the concepts, the final plans and specifications, and guide you through the construction to make sure the project turns out on time, and on budget.

## Consulting

Its not always about big projects. Sometimes you just need a one-day visit to the golf course or a second opinion on a matter. Our goal is to develop long-term relationships with our clients so that we can be there for you, whenever, and for whatever, you need.



# Portfolio



The Ranch Golf Club, Southwick, MA Hole 1 Par 5  
Services: New Course Development  
Upscale Daily Fee with Residential Development





The Champions Course - La Costa Resort & Spa, Carlsbad, CA Hole 7 Par 4  
Services: Master Planning, Total Renovation  
Resort with Non-Equity Membership





The Legends Course - La Costa Resort & Spa, Carlsbad, CA Hole 15 Par 4  
Services: Master Planning, Total Renovation  
Resort with Non-Equity Membership





Monarch Dunes, Nipomo, CA Hole 6 Par 5  
Services: New Course Development  
Upscale Daily Fee with Residential Development







Indian Pond CC, Kingston, MA Hole 12 Par 4  
Services: New Course Development  
Private Club with Residential Development





La Quinta CC, La Quinta, CA Hole 18 Par 4  
Services: Master Planning and Remodeling  
Private Equity Club  
Host to the PGA Tour/Humana Challenge





Murasaki CC, Chiba, Japan Hole 6 Par 3  
Services: Master Planning and Remodeling  
Private Equity Club





Nemu Golf Resort, Mie Prefecture, Japan  
Services: Master Planning and Remodeling  
Golf Resort





The Challenge Course at Monarch Dunes, Nipomo, CA Hole 11 Par 3

Services: New Course Development

Upscale Daily Fee with Residential Development





The Challenge Course at Spurwing, Meridian, ID Hole 3 Par 3

Services: New Course Development

Non-Equity Club with Residential Development





Gleneagles Country Club – Kings Course, Plano, TX  
Hole 15 Par 5  
Services: Master Planning and Remodeling  
Non-Equity Club with Residential Development



# About Us



Damian Pascuzzo began his career working with famed designer Robert Muir Graves. In 1991, he became the principal designer and partnered with Graves to form Graves & Pascuzzo based in El Dorado Hills, California. Pascuzzo has worked on a broad range of projects from residential and resort developments to the master planning and remodeling of existing courses, throughout North America and Asia. In 2001 he was elected President of the American Society of Golf Course Architects. Pascuzzo continues to play an active role in the leadership in the ASGCA.

In 2006, longtime veteran of the PGA Tour, Steve Pate joined with Damian Pascuzzo to form Pascuzzo & Pate Golf Course Design. Steve brings his vast knowledge of golf and playing strategy gained from competing on the great courses of the world for over 30 years. Pate's professional career includes six PGA Tour wins, and membership on two Ryder Cup teams.

Pascuzzo and Pate have made a commitment to treat each design commission as a unique undertaking. Damian and Steve are directly involved in every one of their projects whether it is a new golf course, or the remodeling of an existing facility. The firm has built a significant design portfolio for an array of clients in both the public and private sectors. Their completed works have become well known for meeting their client's goals, being popular with golfers, and gaining national recognition.

With their combined expertise and the knowledge gained from over 50 years in the golf industry, Pascuzzo & Pate's projects reflect innovative and creative solutions for their clients.





## **Damian Pascuzzo, ASGCA**

Bachelor of Science, Landscape Architecture  
California State Polytechnic University, San Luis Obispo, 1981  
Joined the firm of Robert Muir Graves in 1982  
Principal of Graves & Pascuzzo 1991-2006  
Principal of Pascuzzo & Pate, 2006

### PROFESSIONAL ACTIVITIES

Past President, American Society of Golf Course Architects (ASGCA)  
Associate Member, Golf Course Superintendents Association of America  
Member, Golf Course Superintendents Association of Northern California

### REPRESENTATIVE PROJECTS- NEW GOLF COURSES

Maderas Golf Club	Poway, California
Monarch Dunes-The Old Course	Nipomo, California
Monarch Dunes-The Challenge Course	Nipomo, California
The Ranch Golf Club	Southwick, Massachusetts
The Challenge at Spurwing	Meridian, Idaho
The Institute	Morgan Hill, California
Thunder Canyon Country Club	Carson City, Nevada
Meadowood Golf Course	Spokane, Washington
Indian Pond Country Club	Kingston, Massachusetts
Paradise Valley Golf Club	Fairfield, California
Sterling Hills Golf Club	Camarillo, California
The Bridges at Gale Ranch	San Ramon, California



### LECTURER IN GOLF COURSE DESIGN

USGA Regional Seminars	GCSAA National Conference
PGA Continuing Education Program	National Golf Foundation
Urban Land Institute	

### REPRESENTATIVE PROJECTS- REMODELED GOLF COURSES

La Costa Resort Champions Course	Carlsbad, California
La Costa Resort Legends Course	Carlsbad, California
La Quinta Country Club	La Quinta, California
Big Canyon Country Club	Newport Beach, California
Gleneagles Country Club	Plano, Texas
Otaru Country Club	Sapporo, Japan
Blackhawk Country Club	Danville, California
The Lakes Country Club	Palm Desert, California
Gleneagles Country Club	Plano, Texas
Black Butte Ranch	Bend, Oregon
Willow Creek Country Club	Sandy, Utah
Murasaki Country Club	Chiba, Japan
Tarume Country Club	Tarume, Japan
Fincastle Golf Club	Bluefield, Virginia
Coto de Caza Country Club	Coto de Caza, California
Aliso Viejo Golf Club	Aliso Viejo, California



## Steve Pate, PGA

Bachelor of Science, Psychology  
University of California Los Angeles, 1984  
Joined the PGATOUR 1983  
Principal of Pascuzzo & Pate, 2006

### PGA TOUR VICTORIES

1987 Southwest Golf Classic.  
1988 MONY Tournament of Champions  
1988 Shearson Lehman Hutton Andy Williams Open.  
1991 Honda Classic.  
1992 Buick Invitational of California.  
1998 CVS Charity Classic

### PGA NATIONWIDE TOUR VICTORIES

2010 Pacific Rubiales Bogota Open

### INTERNATIONAL TEAMS

1991 & 1999 Ryder Cup  
1989 Kirin Cup  
1991 Dunhill Cup

### REPRESENTATIVE PROJECTS- NEW GOLF COURSES

Monarch Dunes -The Old Course            Nipomo, California  
Monarch Dunes - The Challenge Course Nipomo, California  
The Challenge at Spurwing                    Meridian, Idaho

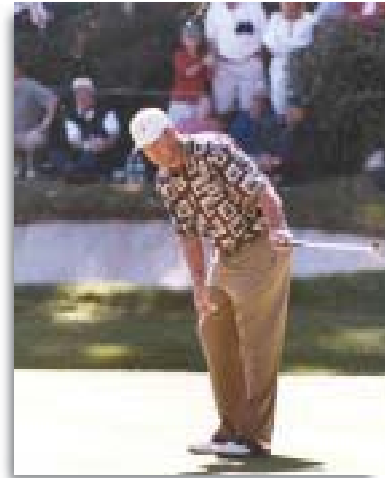

1999 Ryder Cup



2010 Victory



### REPRESENTATIVE PROJECTS - REMODELING

La Costa Resort Champions Course            Carlsbad, California  
La Costa Resort Legends Course            Carlsbad, California  
Big Canyon Country Club                    Newport Beach, California  
Fincastle Golf Club                            Bluefield, Virginia  
Murasaki Country Club                        Chiba, Japan  
Coto de Caza Country Club                    Coto de Caza, California  
Gleneagles Country Club                      Plano, Texas.



# Clients



County of San Luis Obispo General Services Agency

## County Parks

Janette D. Pell, General Services Agency Director

Pete Jenny, Deputy Director-County Parks

Josh Heptig  
Director of Golf Operations  
County of San Luis Obispo  
1087 Santa Rosa Street  
San Luis Obispo, CA 93408

June 19, 2008

To whom it may concern:

I am pleased to write this letter of recommendation for Damian Pascuzzo. I was able to work with Damian at one of our three county golf courses, Chalk Mountain, during a renovation. He was the designer and architect for a bunker renovation, in which the intent was to reshape the bunkers to the original design.

During Damian's service with us I admired him for his ability to foresee potential problems before construction work was actually started and more importantly, in our situation, was his ability to match the objective with available funding. As construction commenced, Damian made himself available as needed and his versatility to adjust design features on the spot was quite valuable.

Damian has a knack for recreating the naturalism we desired from the project while still maintaining aspects within the design to fit our maintenance ability and standards. As I stated above we have three courses that I oversee here on the Central Coast. We have master plans established for each property and Damian will be asked to bid our future projects. If not part of our structure, I would not require him to submit bids, as I was that pleased with the renovation he helped us complete.

Our golfers input is ultimately what we base our ability to provide for our community and they have had nothing but good things to say of our renovation this past fall. Golfers are not always the easiest group of people to impress, so with that I would recommend Damian as an excellent choice for any upcoming golf construction projects.

Sincerely,

Josh Heptig  
Director of Golf Operations



1087 Santa Rosa Street • San Luis Obispo, CA 93408 • Phone: 805.781.5930 • [www.slocountyarks.org](http://www.slocountyarks.org)



## WILLOW CREEK COUNTRY CLUB

ALEX E. NICOLAIDIS, CCM • General Manager

June 29, 2006

To Whom It May Concern:

It is with pleasure that I am able to send you a letter of recommendation for golf course architect Damian Pascuzzo.

We ventured into what began as an information gaining master plan effort but which ultimately culminated into a \$1.5 million renovation under the guidance of Mr. Pascuzzo. Throughout the master plan process, he listened to what the Board and I wanted, what the members wanted, and to what our budgetary requirements were. He always told us what was possible and what may be a pipe dream but he never patronized us and always found creative solutions.

Although previously considered by most, even the PGA TOUR, as one of the best courses in Utah, once we finished this renovation we now have a product that intertwines all the elements of golf for low and high handicappers—playability, fun, beauty, and challenge that is recognized by all as being of the highest caliber.

I am happy to say that now a little over a year later, and \$47K *under* budget, we are delighted in how the major renovation has matured and come to fruition. We now have a course that is beautiful to look at and appropriately challenging to those who play it.

Sincerely,

Alex E. Nicolaidis, CCM  
General Manager

8504 Willow Creek Drive, Sandy, Utah 84093 • PH: 801-942-1054 • FAX: 801-944-9064 • [willowcreekcc.com](http://willowcreekcc.com)



# Media

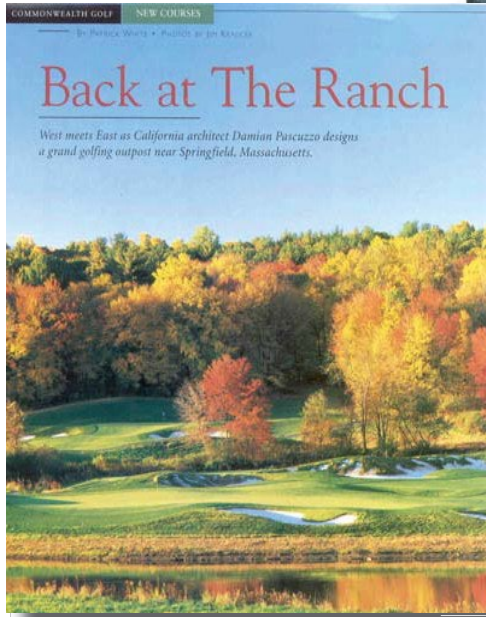

# Distinctions

## Awards

### Monarch Dunes,

*Named one of the Top Ten New Courses in America 2006, by Golf Magazine.  
Best New Course in California 2006 by Fairways and Greens Magazine.  
Finalist in the Best New Development in the U.S. of 2006 by Golf Inc. Magazine.*

### Maderas Golf Club,

*Top 100 Public Courses in America*

### The Ranch Golf Club,

*Named one of the Top Three High End Daily Fee Courses in the U.S. for 2002 by Golf Digest.  
Best New Course in New England for 2002 by New England Journal of Golf.*

### Otaru Country Club

*Named in the Top Ten Golf Courses in Japan by Golf Classic Magazine*

### The Challenge Courses: Monarch Dunes and Spurwing

*ASGCA Design Excellence Award*

## Tournament Venues

La Costa Resort & Spa

PGA Tour, LPGA Tour, 2014 California Amateur

La Quinta Country Club

PGA Tour

Big Canyon Country Club

2014 USGA Senior Amateur

Willow Creek Country Club

PGA Web.Com Tour Utah Classic

Otaru Country Club

Japan Open Championship 1999, Sun Chlorella Classic, Hokkaido Open

Murasaki Country Club

Japan Open 2020

